

trigger shifter

1. remove grip shifter

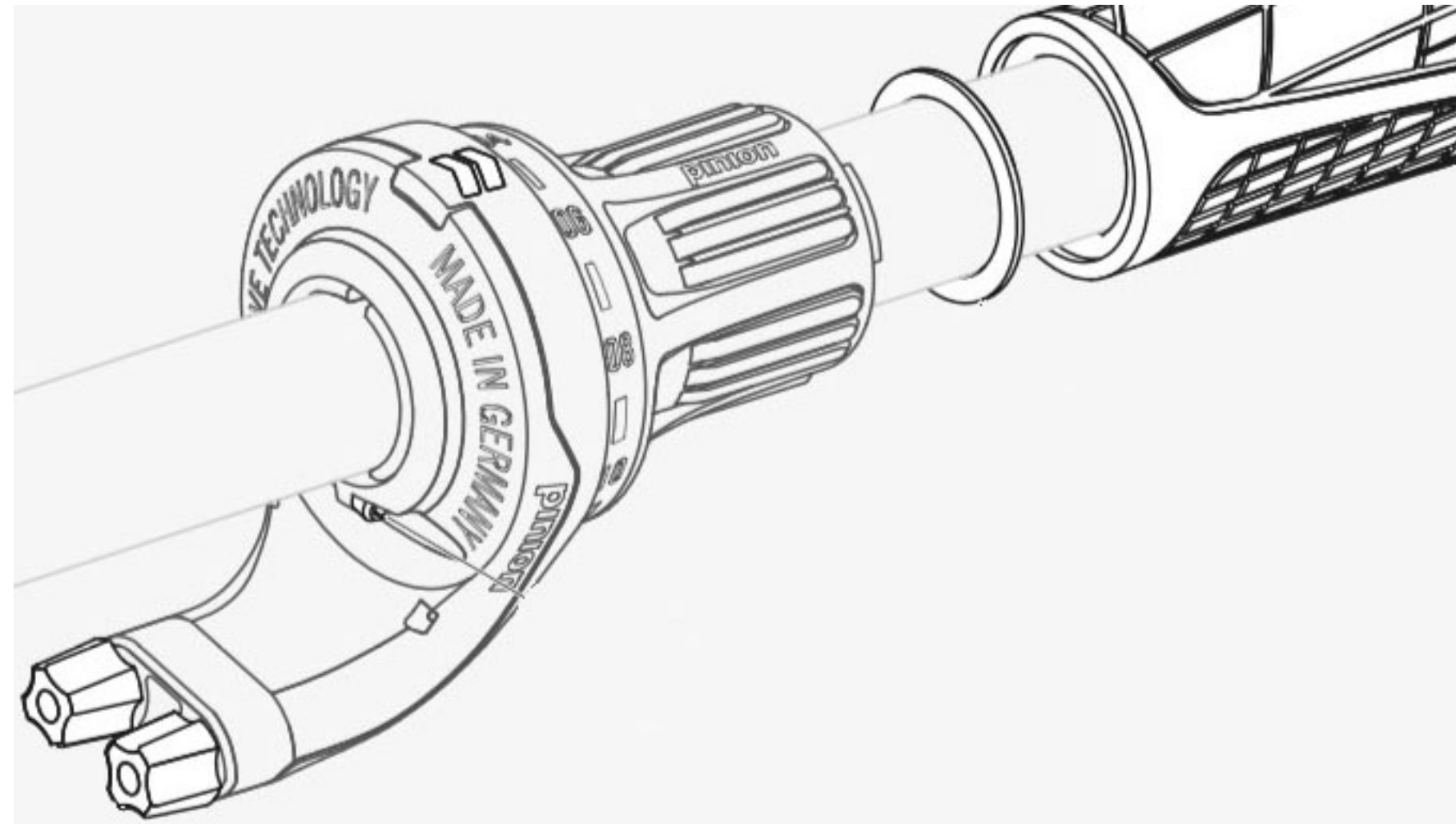

If you have a Pinion DS2 rotary shifter installed you will need to remove the grip and shifter. Loosen the shift cables.

2. remove shift box

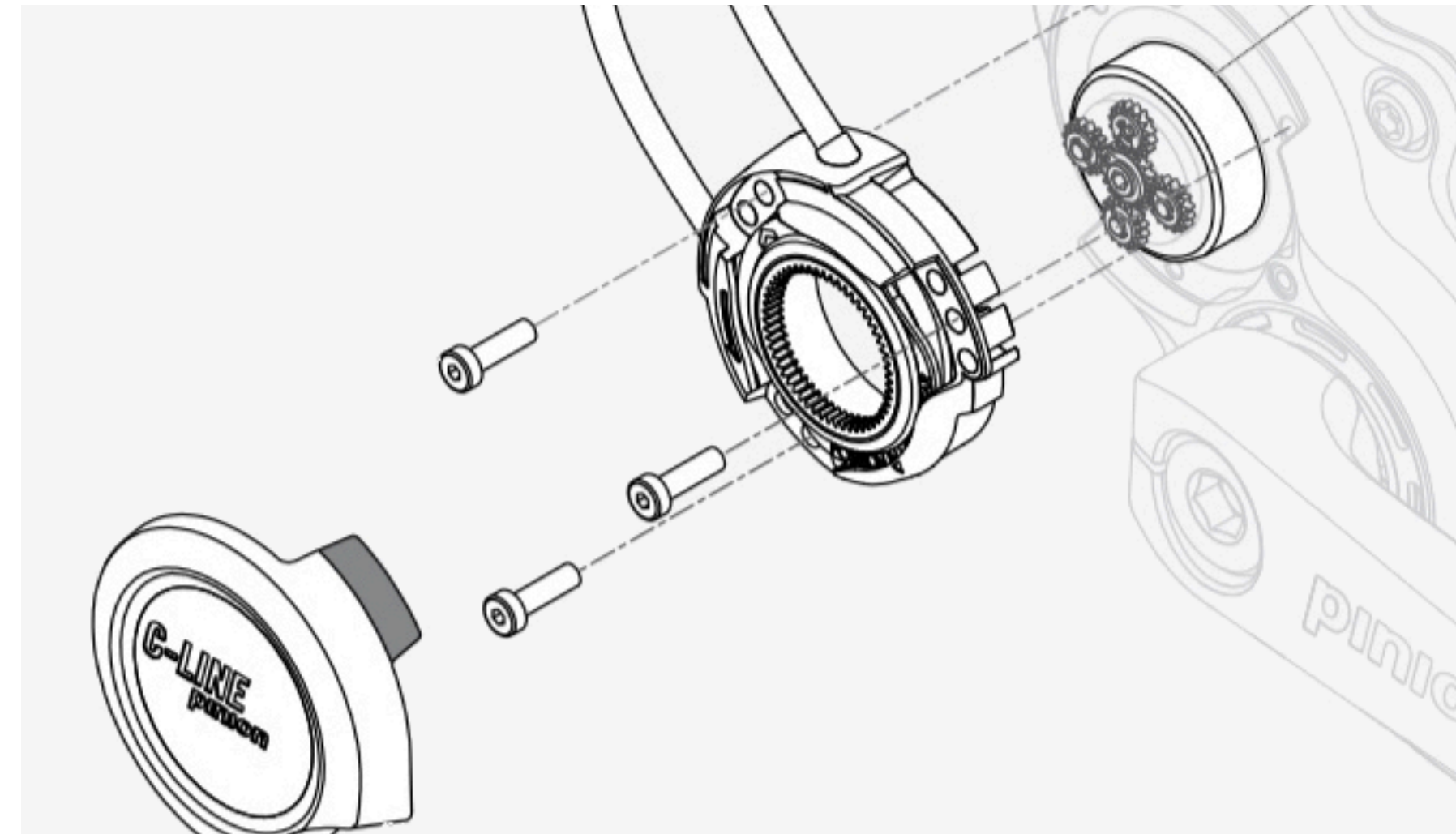

Remove the C-line plastic cap, loosen the 3 screws and remove the shift box. Leave the bowden cables in place, only remove the inner cables. You will need the three screws.

3. install shiftbox



Lead the inner cables of the Cinq into the bowden cables and Install the Cinq shiftbox on the Pinion gearbox with the same screws. Tighten with 1.5Nm.

4. install levers

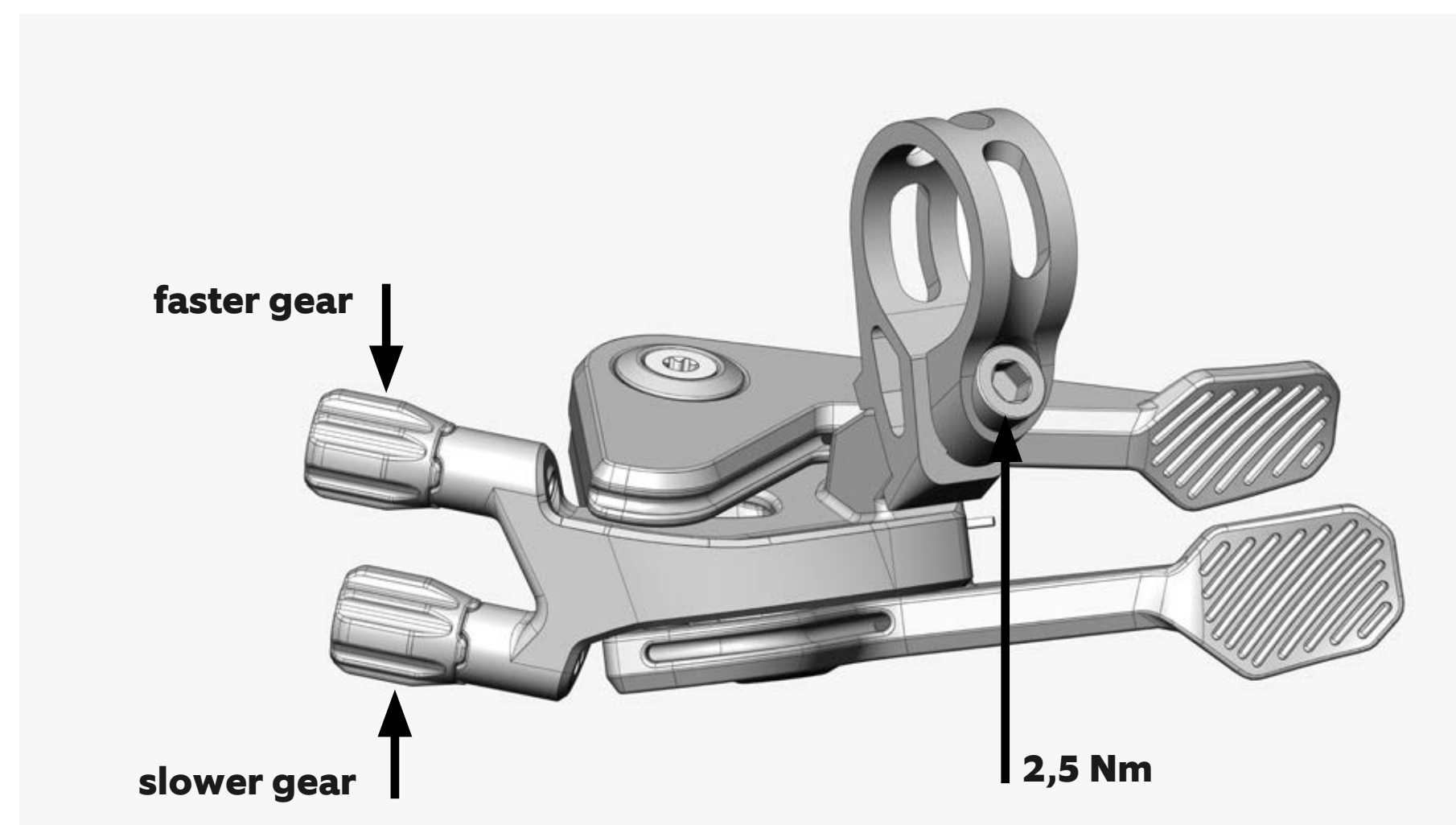

Fix the trigger shifter to the handlebar. Tighten the screw with 2,5 Nm. Lead the correct innercables through the barrel adjusters.

5. install cables

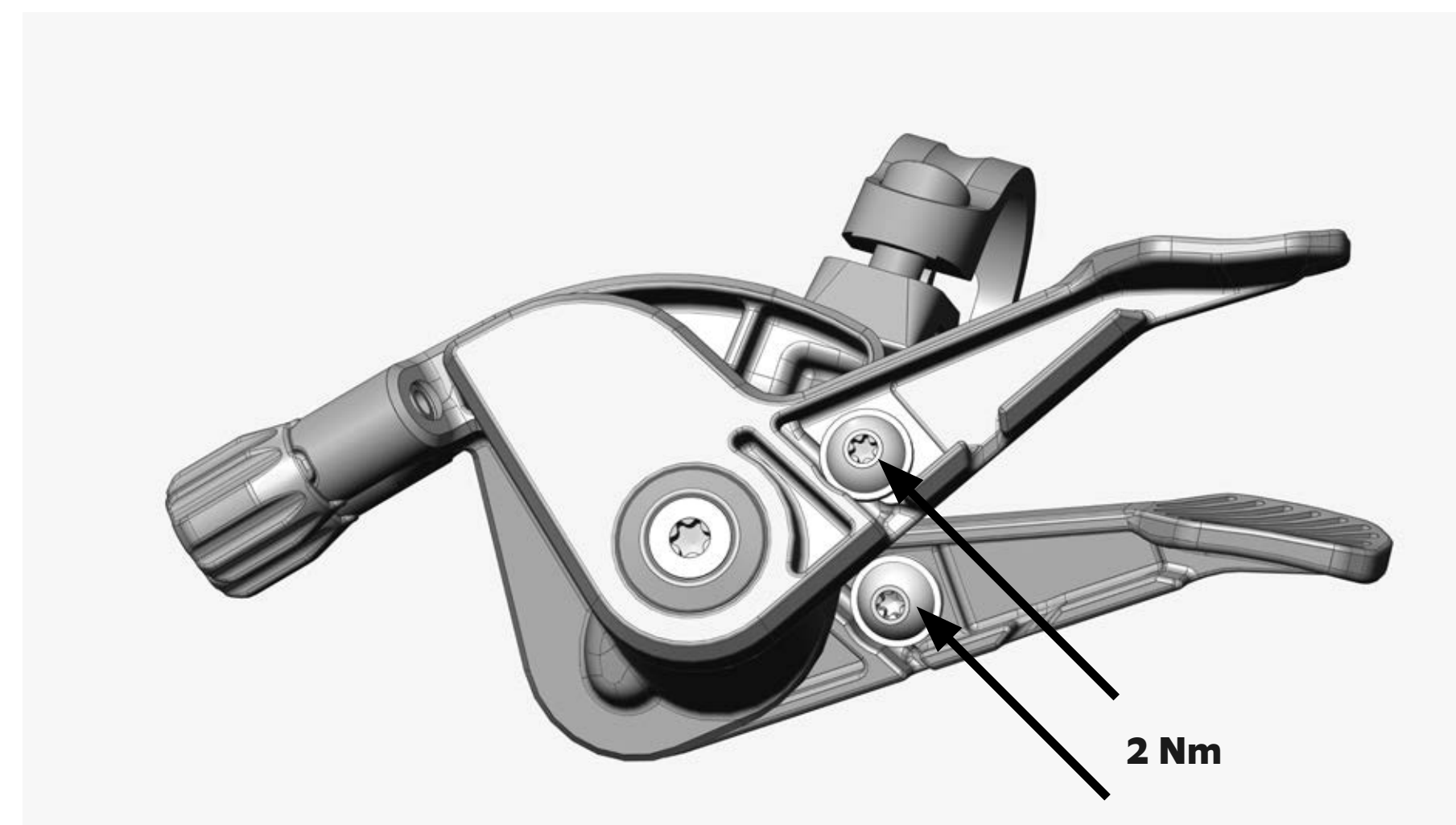

Check if the barrel adjusters are in their middle position by rotating them. Lead the innercable through the correct shifter and fix them with the screws. Tighten them with 2 Nm.

6. adjusting

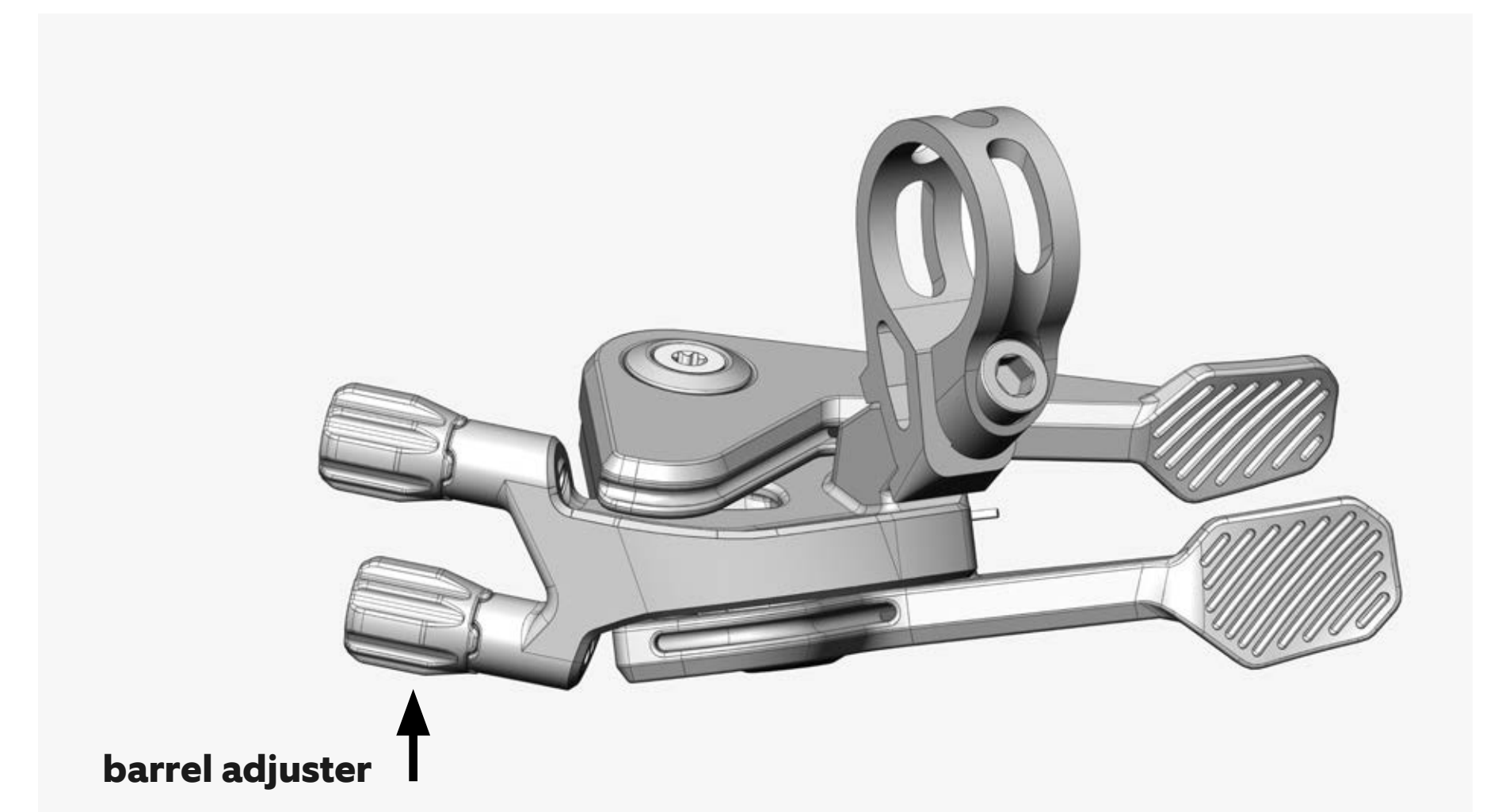

Rotate the barrel adjusters both a bit outward to add some tension. If there is a grinding sound while shifting, rotate the opposite adjuster inwards and the other outwards, till there is no sound and shifting is smooth.